

# SKINCARE

## EASY INSTALLATION INSTRUCTIONS

### STEP 1

Remove your existing shower head. To remove, turn the existing shower head in a counterclockwise direction.

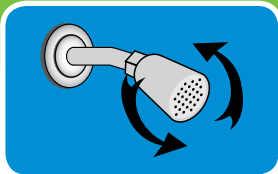

### STEP 2

Remove any remnants of old plumber's tape and flush out shower pipe for 5 to 10 seconds.

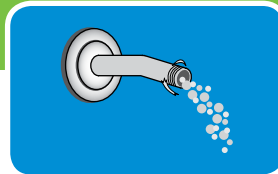

### STEP 3

Wrap plumber's tape clockwise 3 or 4 turns around threaded end of shower arm.

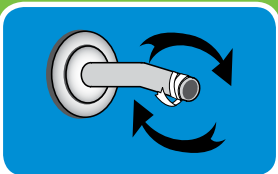

### STEP 4

In a clockwise direction, screw your new shower head onto the taped portion of the shower arm. Hand tighten only.

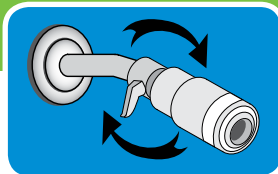

### WHAT'S INCLUDED

- + Fixed Shower Head
- + Plumber's Tape



**NO TOOLS NEEDED**

### USING THE COMFORT CONTROL

Located at the top of the SkinCare® shower head, the comfort control regulator allows you to adjust from a gentle stream to an invigorating spray.

Note: The comfort control regulator is not a shut off valve. When turned to the lowest position, the shower head continues to flow. This is a normal safety feature. Unit may be in lowest flow (gentle stream) position during shipping. Please check the position of comfort control regulator upon installation.

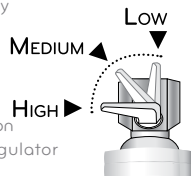

# STOP! NEED HELP?

**PLEASE DO NOT RETURN THIS PRODUCT TO THE STORE.**

If you need installation assistance, replacement parts or have questions regarding our warranty please contact customer service at

Support is also available via email at [support@watersaving.ca](mailto:support@watersaving.ca)

Be sure to visit our website at [www.watersaving.ca](http://www.watersaving.ca)

Business Hours:  
Monday-Thursday 7:00 am to 5:00 pm PST  
Friday 7:00 am to 4:30 pm PST

